



Operation and Maintenance Instructions

for

CS Motor-driven grease pump

NANJING BIJUR MACHINERY PRODUCTS, LTD.

Tel: 86-25-85801188 Toll Free: 800-8286000 Fax: 86-25-85802288

Website: <http://www.bijur.com.cn> E-mail: china@bijur.com.cn



Before installing or operating this product, please read this manual carefully. Failure to follow instructions can result in damage to the product and/or serious bodily injury.



Before performing service to product, always turn off and disconnect electrical power.



When connecting product, make sure that unit is securely and adequately grounded. Failure to ground properly may cause serious injury.

Table of Contents

1. General	page 3
2. Technical Data	page 3
3. Pump NO. & Specification	page 4
4. Dimension	page 5
5. Principle	page 7
6. Notice	page 7
7. Troubleshooting	page 8

Attachment: Product Quality Feedback Sheet

1, General

CS grease pump is driven by a DC or AC motor , It is ideal for PDI lubricant system.

There is a built-in controller which monitor the pump to deliver rated amount of lubricant to lubrication point in right time.

There are two models ,the small capacity CS grease pumps and the large capacity CS grease pumps,which have 1~3 outlet.Each pump outlet has an over pressure protection valve and each outlet can support a lubrication system independently.

Reservoir capacity of the large capacity CS grease pumps is 2~8L. There are two kinds of reservoirs, the metal reservoir and the plastic reservoir. Low level switch is stationed when needed by the system. Besides, the metal reservoir stations high level switch.

2, TECHNICAL DATA

1, DELIVERY VOLUME OF EACH OUTLET : DC GREASE PUMP: 5.5ml/min

AC GREASE PUMP: 3 ml/min

2, MAX WORKING PRESSURE: 25Mpa

3, GREASE: NLGI000#-2#

4, OUTLET THREAD SPEC: Z1/4

M12×1.5、NPTF1/4 and Rp1/4 are also available.

5, MOTOR: DC MOTOR 12VDC: 70W

24VDC: 50W

AC MOTOR 60W

6, LEVEL SWITCH: 220V 1A

3, Pump NO. & SPECIFICATIONS

PUMP NO.	TYPE	MOTOR VOLTAGE	RESERVOIR	MODEL	LEVEL SWITCH
22438-X	CS160	12VDC	2L PLASTIC RESERVOIR	SMALL	NO
22449-X	CS260	24VDC			
25285-X	CS360	220VAC			
25290-X	CS460	380VAC			
28286-X	CS560	110VAC			
25212-XXX	CS160	12VDC	AS FOLLOWS	LARGE	AS FOLLOWS
25217-XXX	CS260	24VDC			
25218-XXX	CS360	220VAC			
25219-XXX	CS460	380VAC			
25220-XXX	CS560	110VAC			

INSTRUCTION of CODE NAME:

1, SMALL MODEL

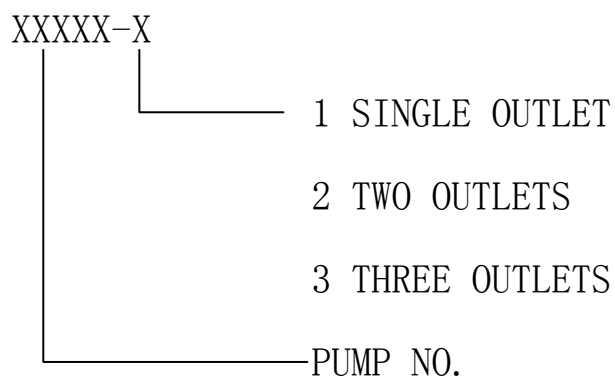

2, LARGE MODEL

XXXXX-XXX

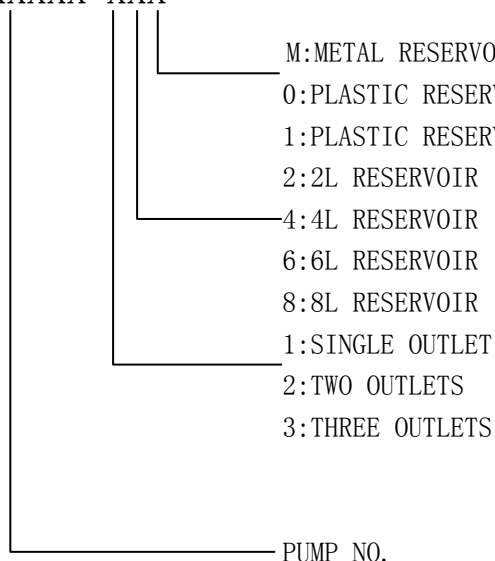

- M: METAL RESERVOIR , WITH LOW LEVEL SWITCH
- O: PLASTIC RESERVOIR , WITHOUT LOW LEVEL SWITCH, NO 2L MODEL
- 1: PLASTIC RESERVOIR , WITH LOE LEVEL SWITCH
- 2: 2L RESERVOIR
- 4: 4L RESERVOIR
- 6: 6L RESERVOIR
- 8: 8L RESERVOIR
- 1: SINGLE OUTLET
- 2: TWO OUTLETS
- 3: THREE OUTLETS

INDICATIONS: If a letter “k” is behind of code name, it just indicates that the CS grease pump is for Korea.

4, DIMENSIONS

1, SMALL DC MOTOR GREASE PUMP

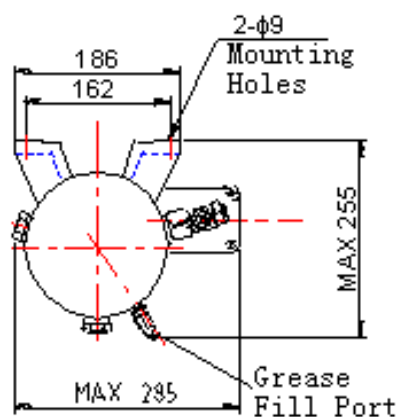
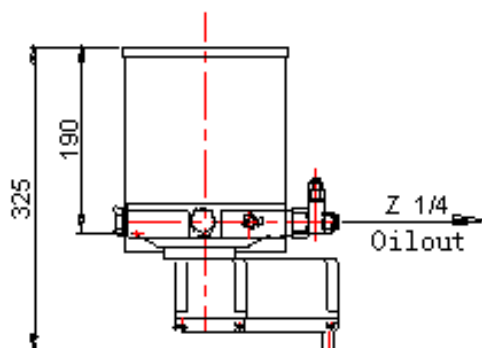

2, SMALL AC MOTOR GREASE PUMP

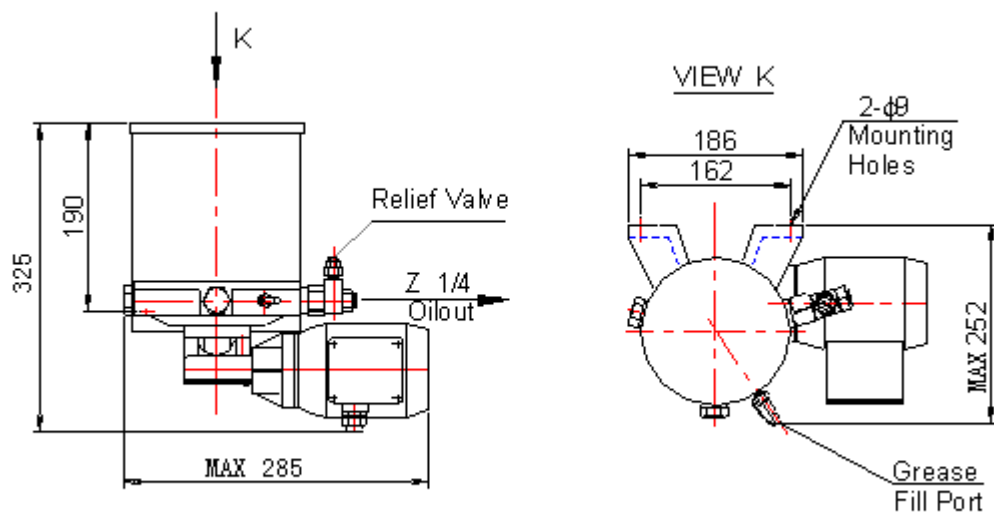

3, LARGE DC MOTOR GREASE PUMP

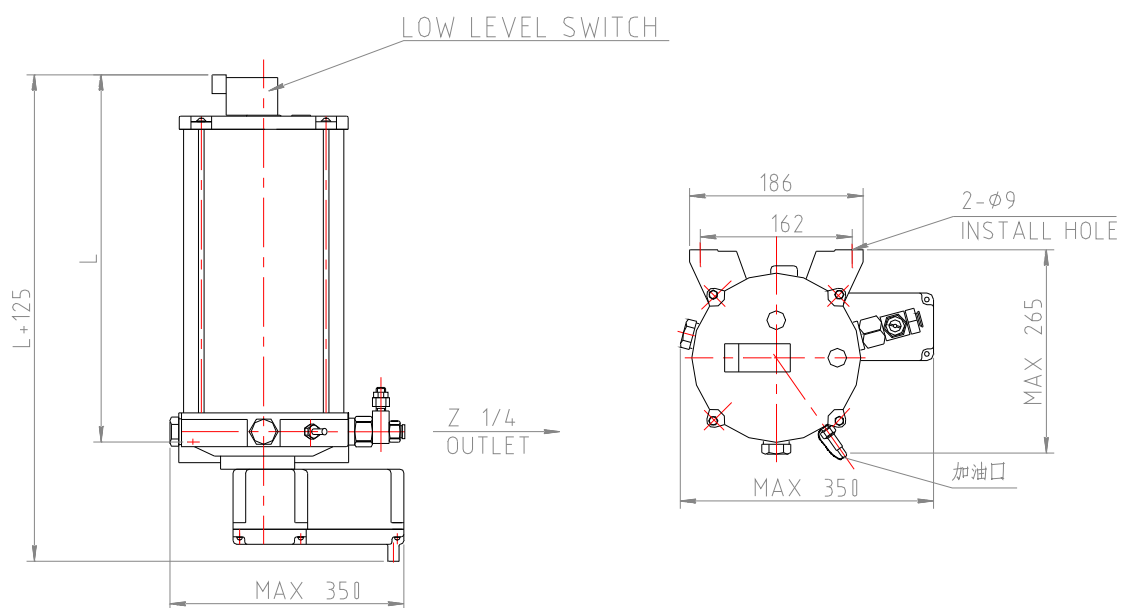

LOW LEVEL SWITCH

L+125

OUTLET NPT 1/4

186

162

2-Ø 9 INSTALL HOLE

Grease Fill Port

MAX 350

MAX 265

GREASE FILL PORT

The grease pump is driven by a DC or AC motor. And it drives a worm and worm wheel then rotation is transferred to a eccentric wheel which drives the piston to move back and forth, the lubricant is sucked into the pump body and then discharge at the outlet.

- 1, The motor must be securely and adequately grounded.
- 2, The power voltage must be correct. The motor's rotating direction must be same as the label.

- 3, The grease used must be clean.
- 4, Filling the grease from the designate part.
- 5, Please check the safety valve in the order time.

7. TROUBLESHOOTING

Symptom	Possible cause	Remedy
No discharge at outlet	1. Motor can't rotate	Check power and motor
	2. Motor rotate reversely	Connect the wires according to the wiring diagram
	3. Air at the bottom of reservoir	Exhaust air
Pressure can't build	1. Leakage at junctions	Check the pipeline
	2. Pump body broken	Contact Nanjing Bijur